

Thermonet Mesh 150W/m²

For Installation Directly Under Tile

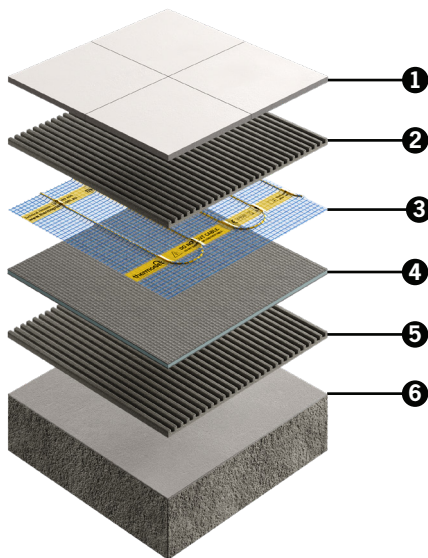

- ❶ Tiled floor finish
- ❷ Flexible tile adhesive
- ❸ Thermonet 150W/m² heating mat
- ❹ Optional Econoboard insulation board
- ❺ Flexible tile adhesive (if insulation is installed)
- ❻ Prepared concrete or timber substrate



Lifetime Warranty

We are so confident of the quality of our German-made Thermonet Underfloor Heating that we give each system a warranty that lasts a Lifetime.



TwistedTwin cable construction

The unique stress free cable construction creates a longer lasting heating cable with zero electromagnetic field (Zero EMF).



Fully self adhesive mesh

The self adhesive mesh speeds up installation by holding Thermonet matting to the substrate for easy self-levelling and tile fixing.



Heating cable protection

Thermonet is installed wire side down which means the heating cable is protected from damage during installation by the hard wearing mesh layer.



Minimal Height Build-up

Utilising innovative extrusion processes provides real 'lay flat' technology that makes installing Thermonet easy. The matting system is only 3.5mm thick with a low profile cold tail of only 4mm thick which is typically concealed within the tile adhesive layer.

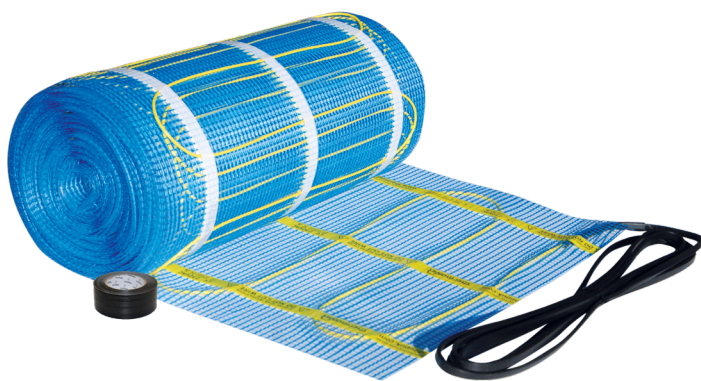

Includes: Thermonet 150W/m² Mat, Fixing Tape, Installation Guide & Warranty Form.

Technical Data

Width	500mm
Heated Width	430mm
Thickness	3.5mm*
Max. Temperature	28°C**
Protection Rating	IP68
Warranty	Lifetime on heating mat
Voltage	240Volt
Wattage	150W/m ²
Conductor Type	Single Ended
Cold Tail Length	5m

*Cold tail is 4mm thick

**Regulated by floor sensing thermostat

Installation Overview

Thermonet electric underfloor heating mat is quick and easy to install. This overview gives a guide to the basics. Always read the instructions in full before attempting your own installation.



1 Plan out the installation
Determine the location of the Thermostat and floor sensor and work out the layout of the heating mat excluding areas under floor mounted fixtures.

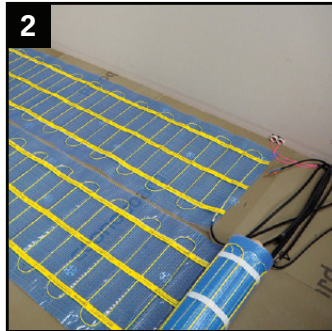

2 Lay out the Thermonet mat
Starting at the Thermostat position, lay out the heating mat according to the plan.

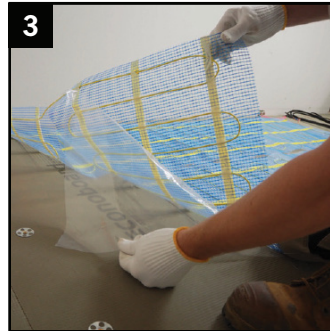

3 Stick down the heating mat
Once the layout is finalised, peel off the clear plastic and stick down the heating mat.



4 Install floor finish
Cover the heating cables with self-levelling compound or tile directly on top using a full bed of tile adhesive.

Thermonet Mesh 150W/m²

Stock Code	Size (m)	Area (m ²)	Output (W)	Amps (A)	Resistance (Ω)
111502	2 x 0.5	1.0	150	0.63	353
111503	3 x 0.5	1.5	225	0.94	235
111504	4 x 0.5	2.0	300	1.25	176
111505	5 x 0.5	2.5	375	1.56	141
111506	6 x 0.5	3.0	450	1.88	118
111507	7 x 0.5	3.5	525	2.19	101
111508	8 x 0.5	4.0	600	2.50	88
111509	9 x 0.5	4.5	675	2.81	78
111510	10 x 0.5	5.0	750	3.13	71
111511	11 x 0.5	5.5	825	3.44	65
111512	12 x 0.5	6.0	900	3.75	59
111513	13 x 0.5	6.5	975	4.06	56
111514	14 x 0.5	7.0	1050	4.38	50
111516	16 x 0.5	8.0	1200	5.00	44
111518	18 x 0.5	9.0	1350	5.63	39
111520	20 x 0.5	10.0	1500	6.25	35
111524	24 x 0.5	12.0	1800	7.50	29
111528	28 x 0.5	14.0	2100	8.75	25
111532	32 x 0.5	16.0	2400	10.00	22